

Installation manual Montážní návod

1. Position screws with leveling tools;
Na zdi vyměřte pozici pro umístění šroubů.

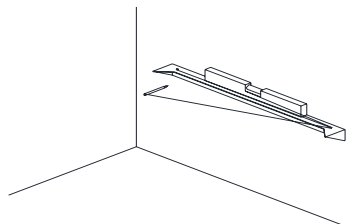

2. Drill holes for screws with 10mm drill;
Otvory pro šrouby vyvrtejte vrtákem o velikosti 10 mm.

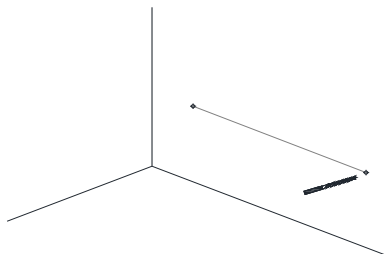

3. Fixing the screws into the holes;
Upevněte šrouby do vyvrtaných otvorů.

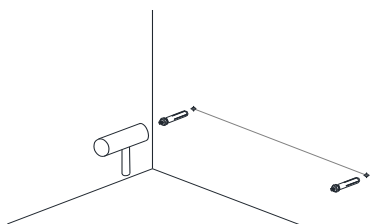

4. Fix the bracket with leveling tools;
Upevněte podpěrnou konzoli ke zdi.

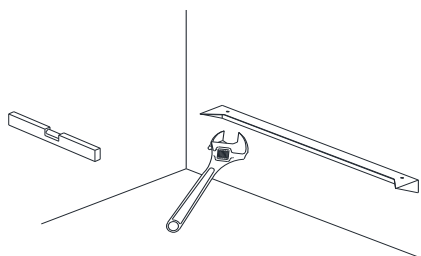

5. Apply glass cements on wall-side;
Aplikujte silikon.

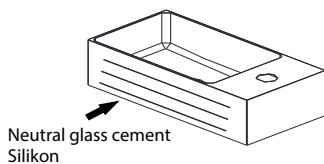

6. Fix basin on the bracket with screws;
Přípevněte umyvadlo k podpěrné konzoli pomocí šroubů.

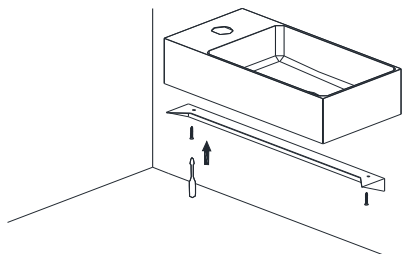

7. Support the basin till the glue dried out;
Podpěrejte umyvadlo, dokud silikon nezaschne.

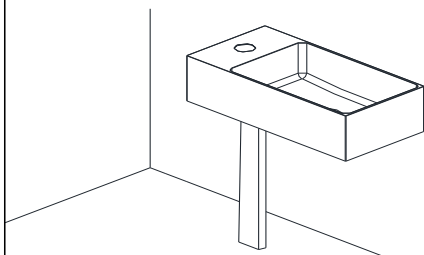

8. Remove support and install the rest.
Po odstranění podpěry je možné nainstalovat sifon a baterii.

